

▶ 断面図

H断面/一般

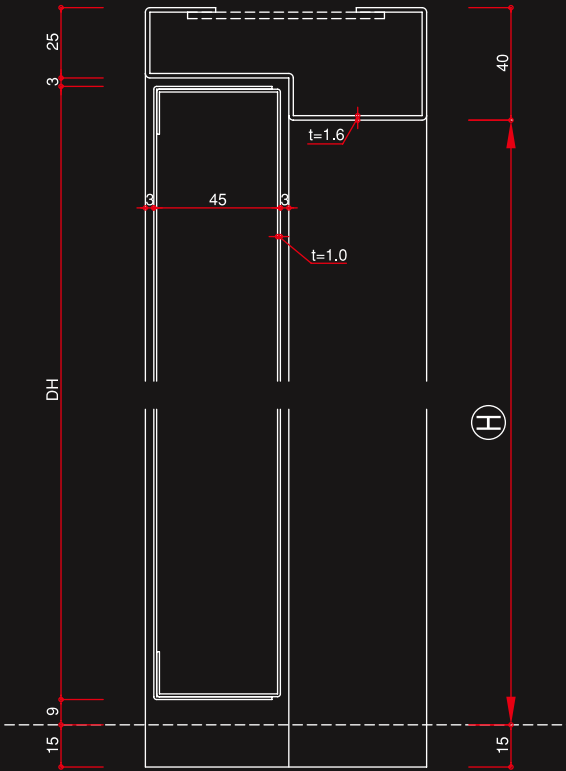

W断面/片開き

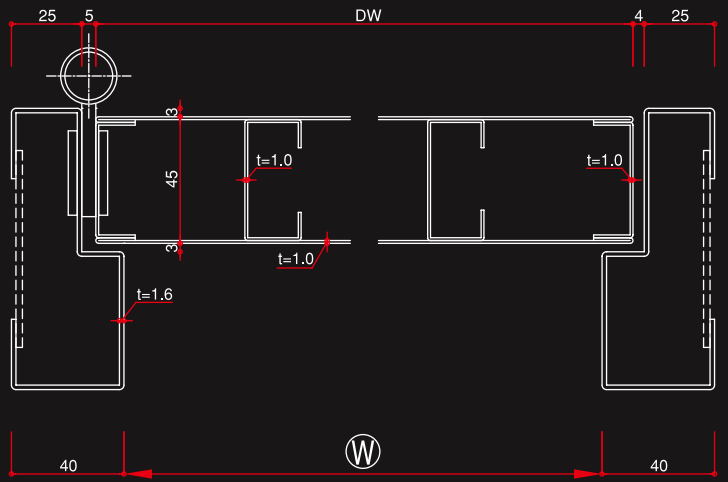

W断面/両開き

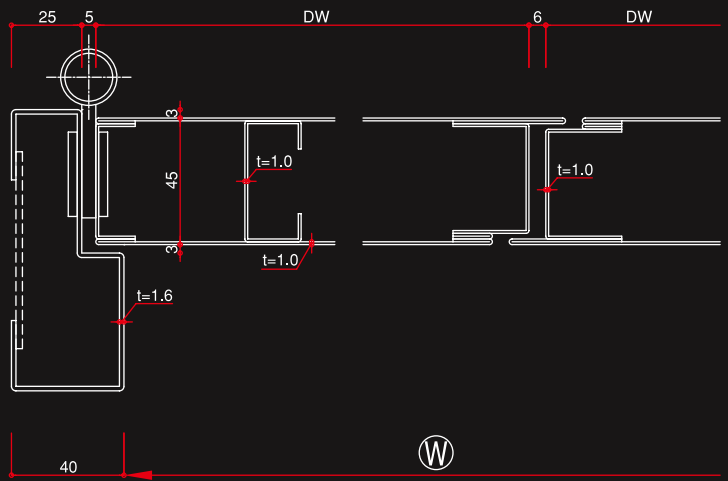

W断面/SAT

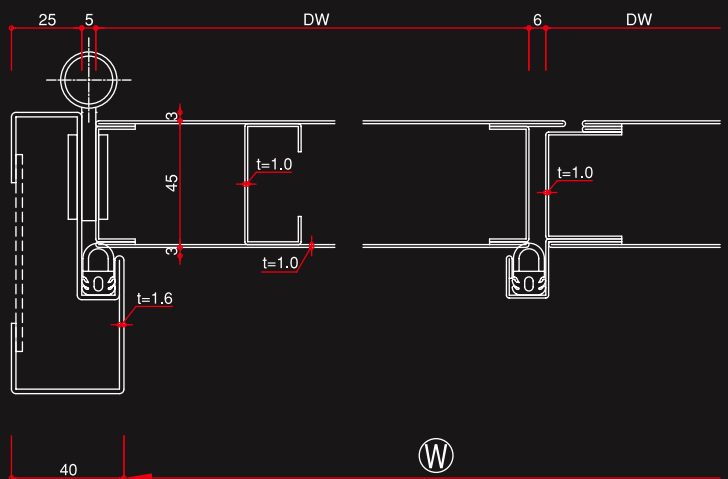

H断面/窓詳細①

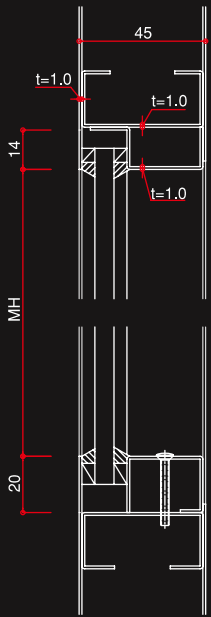

H断面/窓詳細②

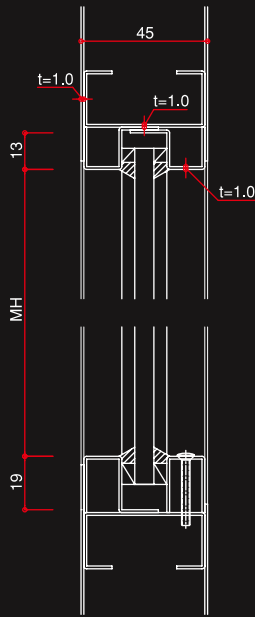

W断面/窓詳細①

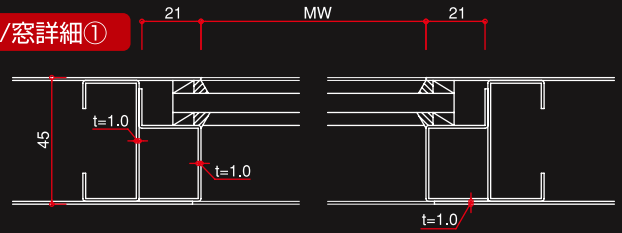

W断面/窓詳細②

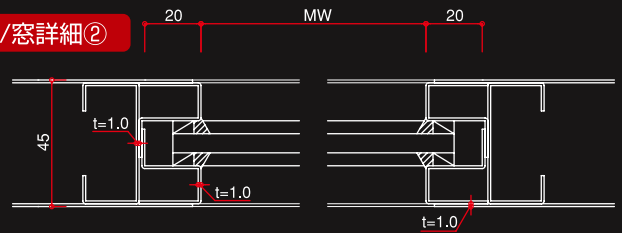

※防火設備対応には網入り板ガラス6.8mmを使用する必要があります。

H断面/ガラリ詳細(山型)

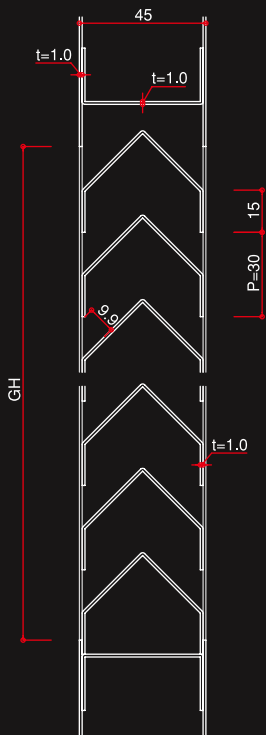

H断面/ガラリ詳細(片流れ)

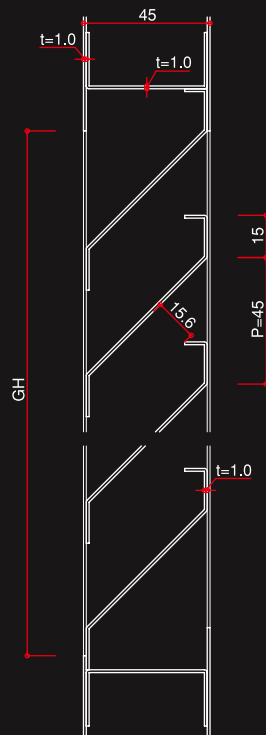

H断面/ガラリ詳細(可動)

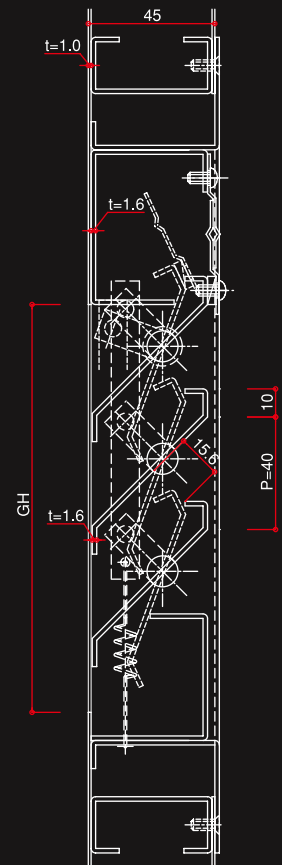

※特定防火設備対応にはヒューズ付可動ガラリを使用する必要があります。